

P.C.B LAYOUT
TOP VIEW
Tolerance: ±0.05

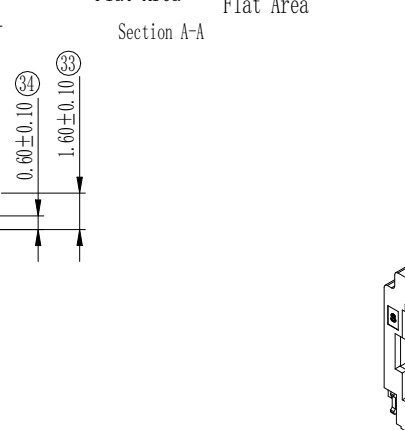

- Performance characteristics:
- Main body part material
Insulator: LCP Nature UL94V-0
Contact terminal: Copper alloy, 1.27 μm Ni under plated,
Contact Area plating Au 0.76 μm Min..
 - Electrical requirements:
Current rating: 0.5 A
Voltage rating: 15 V
Contact resistance: ≤30 mΩ
Insulation resistance: ≥100 MΩ
Withstanding voltage: 250 Vr.m.s, 1mA, 60s
 - Environment specification
Working temperature: -40°C~+125°C
Resistance to soldering heat: 260°C, 30s
 - Packing & storing
Method of packing: Tape & reel, outer box
Storing condition: Temperature of -10°C~+40°C
below 80% relative humidity
 - Style of installation: SMT
 - To prevent the pollution of the environment product info
RoHS agreement: In line with the European Union RoHS.
 - Mating interface must meet the Huawei's requirements.

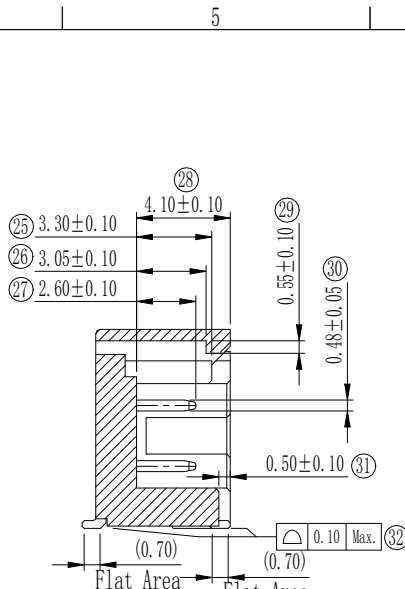
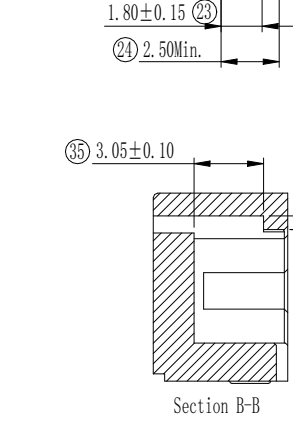
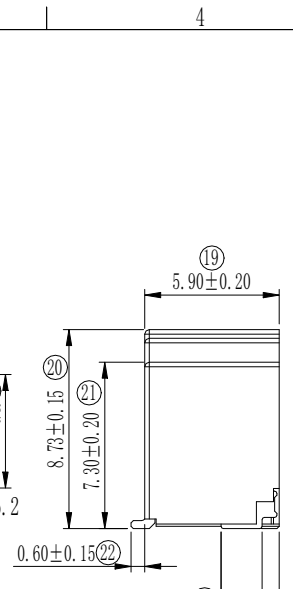
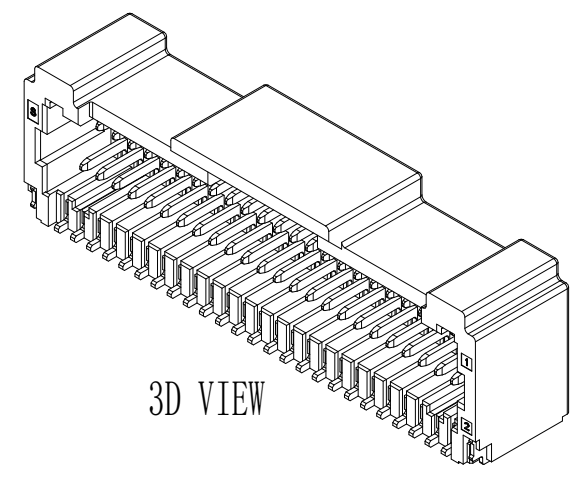

3D VIEW

Unless otherwise specified tolerance:

X.	±0.50	X.°	±3°
.X	±0.38	.X°	±2°
.XX	±0.25		

①	4	202604150170	QCX	2026.04.16
②	2	202510090134	QCX	2025.10.10
Mark	NO.	File NO.	Signature	Date
DRAW	QCX 2025.08.12			
CHK				
MAN				
STD				
APP				

1.00mm Pitch wafer
Type 1

1338-501-54-N

SL0.1338.030			
Projection	Rev.	Weight	Scale
	A2		
All Dimensions in mm		Sheet 1 of 1	
SHENZHEN SHINNING ELECTRONIC CO.,LTD.			